

ECHO PLAZA

309 FRIES MILL ROAD
WASHINGTON TOWNSHIP, NJ 08080

ECHO PLAZA

309 FRIES MILL ROAD
WASHINGTON TOWNSHIP, NJ 08080

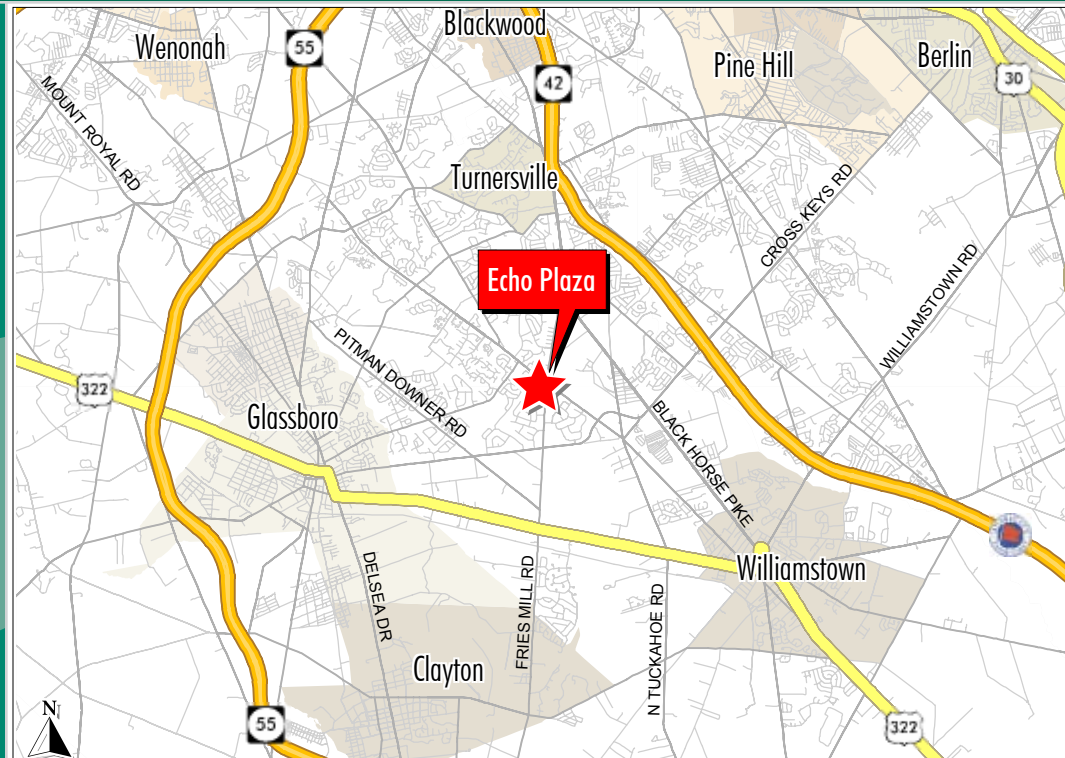

LOCATION & DRIVE TIMES:

Atlantic City - 45 miles, 50 minutes
Philadelphia - 19 miles, 29 minutes
New York City - 100 miles, 1 3/4 hours
Washington DC - 139 miles, 2 3/4 hours

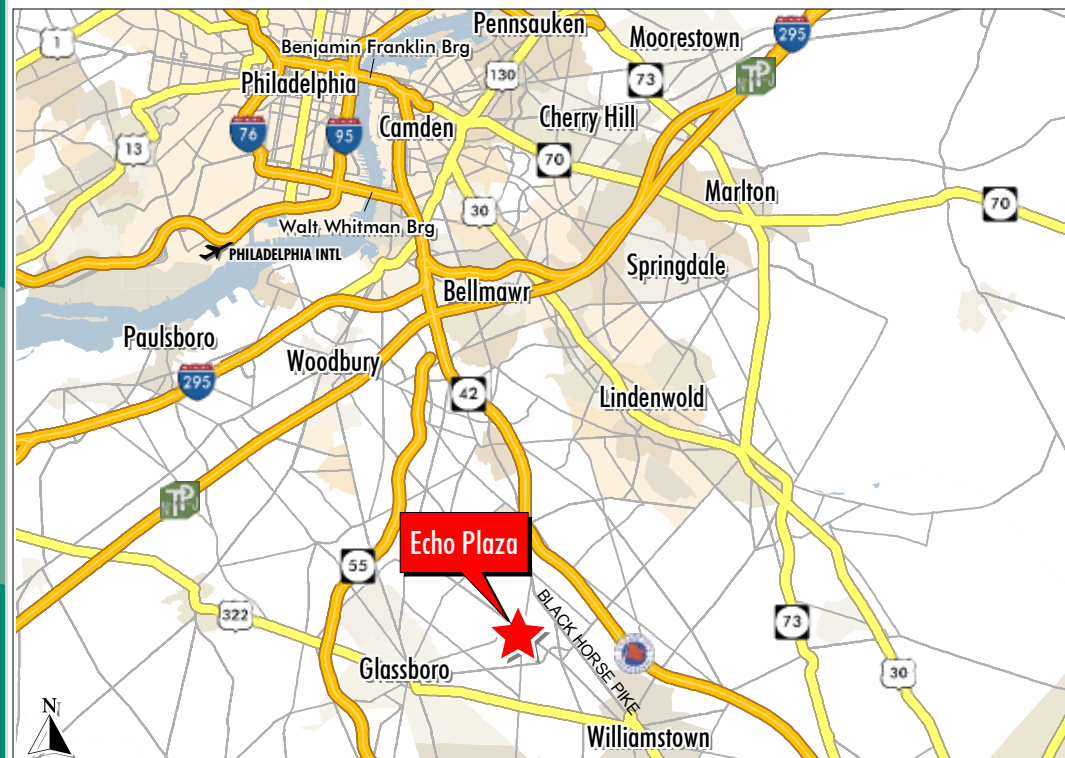

For information, contact:

Gerald Zimmer, SIOR
First Vice President
T 856.355.4174
F 856.985.5074
gerald.zimmer@cbre.com

Daniel McGovern
Senior Associate
T 856.355.4175
F 856.985.5074
dan.mcgovern@cbre.com

CB Richard Ellis, Inc.
4A Eves Drive
Suite 108
Marlton, NJ 08053
Licensed: NJ, PA, DE
T 856.985.9700
F 856.985.5074
www.cbre.com/echoplaza

For information, contact:

Gerald Zimmer, SIOR
First Vice President
T 856.355.4174
F 856.985.5074
gerald.zimmer@cbre.com

Daniel McGovern
Senior Associate
T 856.355.4175
F 856.985.5074
dan.mcgovern@cbre.com

CB Richard Ellis, Inc.
4A Eves Drive
Suite 108
Marlton, NJ 08053
Licensed: NJ, PA, DE
T 856.985.9700
F 856.985.5074
www.cbre.com/echoplaza

From 1,500 SF to 62,000± SF Available

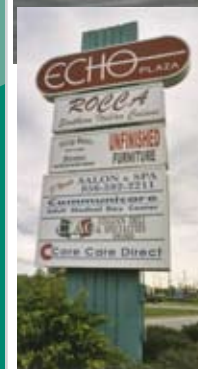

Demographics	1 mile radius	3 miles radius	5 mile radius
2007 Estimate Population	7,323	55,711	149,669
2012 Projected Population	7,802	58,166	157,117
Growth 2007-2012	6.54%	4.41%	4.95%
2007 Est. Avg. Household Income	\$88,542	\$84,017	\$79,563



©2008, CB Richard Ellis, Inc. We obtained the information above from sources we believe to be reliable. However, we have not verified its accuracy and make no guarantee, warranty or representation about it. It is submitted subject to the possibility of errors, omissions, change of price, rental or other conditions, prior sale, lease or financing, or withdrawal without notice. We include projections, opinions, assumptions or estimates for example only, and they may not represent current or future performance of the property. You and your tax and legal advisors should conduct your own investigation of the property and transaction.



©2008, CB Richard Ellis, Inc. We obtained the information above from sources we believe to be reliable. However, we have not verified its accuracy and make no guarantee, warranty or representation about it. It is submitted subject to the possibility of errors, omissions, change of price, rental or other conditions, prior sale, lease or financing, or withdrawal without notice. We include projections, opinions, assumptions or estimates for example only, and they may not represent current or future performance of the property. You and your tax and legal advisors should conduct your own investigation of the property and transaction.



ECHO PLAZA

309 FRIES MILL ROAD
WASHINGTON TOWNSHIP, NJ 08080



UP TO 62,000± RSF BUILD TO SUIT

UNITS FROM
1,500± RSF TO
14,560± RSF

SITE PLAN:

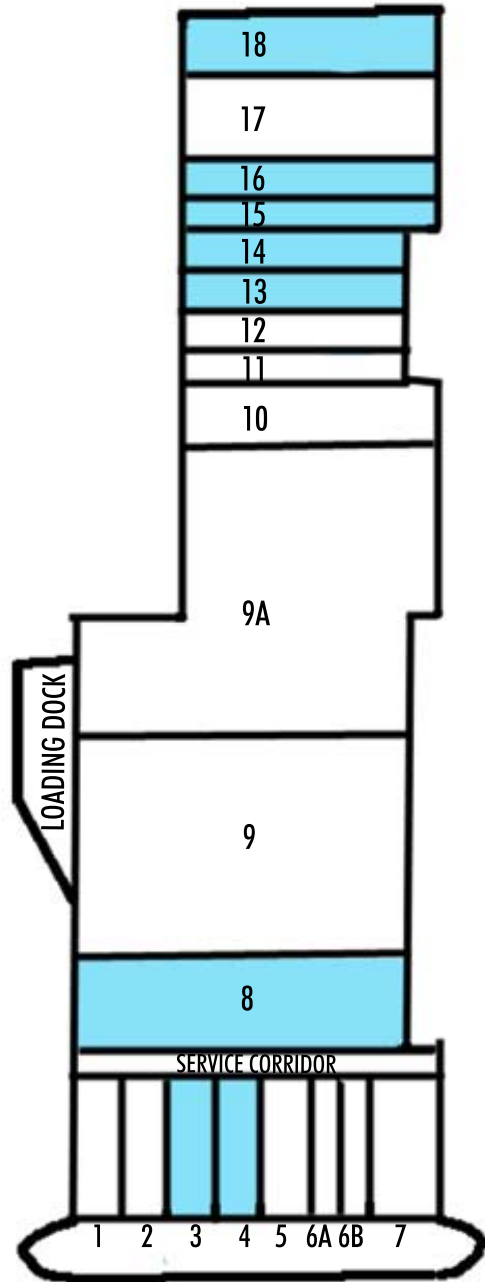

UNITS AVAILABLE:

- ▶ Unit 3 - 1,500± RSF
- ▶ Unit 4 - 1,500± RSF
- ▶ Unit 8 - 13,000± RSF Ground Level
1,560± RSF Mezzanine
- ▶ Unit 13 - 2,200± RSF
- ▶ Unit 14 & 15 - 4,600± RSF
- ▶ Unit 16 - 2,400± RSF
- ▶ Unit 18 - 3,500± RSF



PROPOSED LIFESTYLE CENTER IN ECHO PLAZA

PROPERTY FEATURES:

- From 31,247± - 62,000± RSF Available
- Brand New Construction adjacent to Virtua and Kennedy Hospital's new medical campuses
- Class A office, medical & retail space available
- Located in the fastest growing county in New Jersey
- Building signage available
- Only a 12.39% loss factor

PROPERTY FEATURES:

- * Join Active Fitness and The State of New Jersey
- * Perfect for all office, medical or retail users
- * Located at the signalized intersection of Hurfville Cross Keys Road & Fries Mill Road with entrances from both roads
- * Access to all major arteries in Southern New Jersey
- * Parking ratio of 7 plus per 1,000 SF

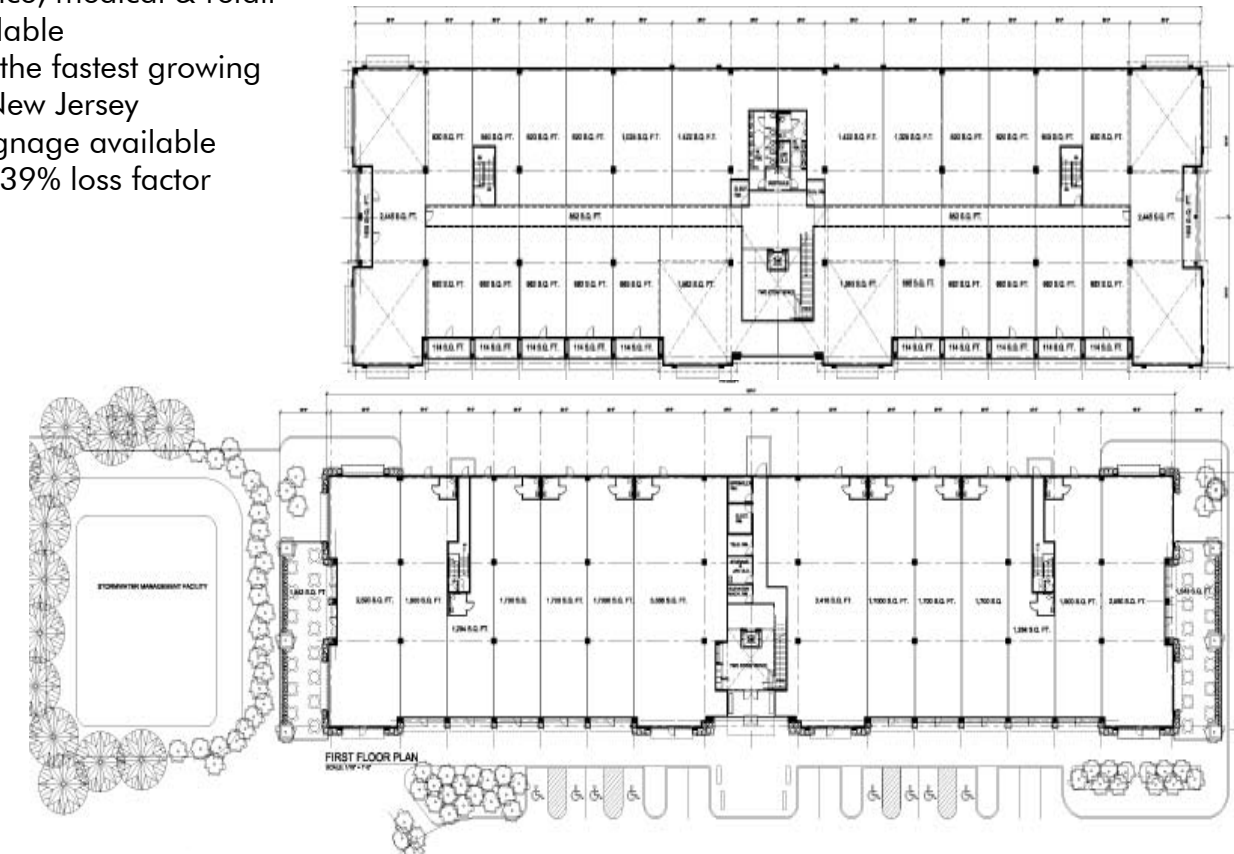

©2008, CB Richard Ellis, Inc. We obtained the information above from sources we believe to be reliable. However, we have not verified its accuracy and make no guarantee, warranty or representation about it. It is submitted subject to the possibility of errors, omissions, change of price, rental or other conditions, prior sale, lease or financing, or withdrawal without notice. We include projections, opinions, assumptions or estimates for example only, and they may not represent current or future performance of the property. You and your tax and legal advisors should conduct your own investigation of the property and transaction.